



8, Latchmere Lodge Bulford Road, Durrington, SP4 8DQ

£825 PCM

## About The Property

This one-bedroom flat is located in the centre of Durrington. Upon entering, you will find an entrance hallway that leads to the bedroom, which features a large double-glazed window, a built-in wardrobe, storage space, and electric heating.

Continuing down the hallway, you will find the bathroom, which has recently been repainted. It includes an electric shower over the bath and benefits from a sizable storage cupboard that houses an insulated hot water cylinder, along with ample space for linen and towels.

At the far end of the flat is a well-proportioned kitchen/diner/lounge area, complete with wood-effect vinyl flooring. The modern kitchen is equipped with a ceramic electric hob, an electric fan oven, and space for an undercounter fridge/freezer, as well as a washing machine.

The flat is available for long-term rental and is offered unfurnished

- One bedroom flat
- Modern kitchen
- Recently redecorated
- Allocated parking
- Electric heating
- Unfurnished
- Long term tenancy
- EPC C





## Ground Floor

Approx. 45.0 sq. metres (484.2 sq. feet)

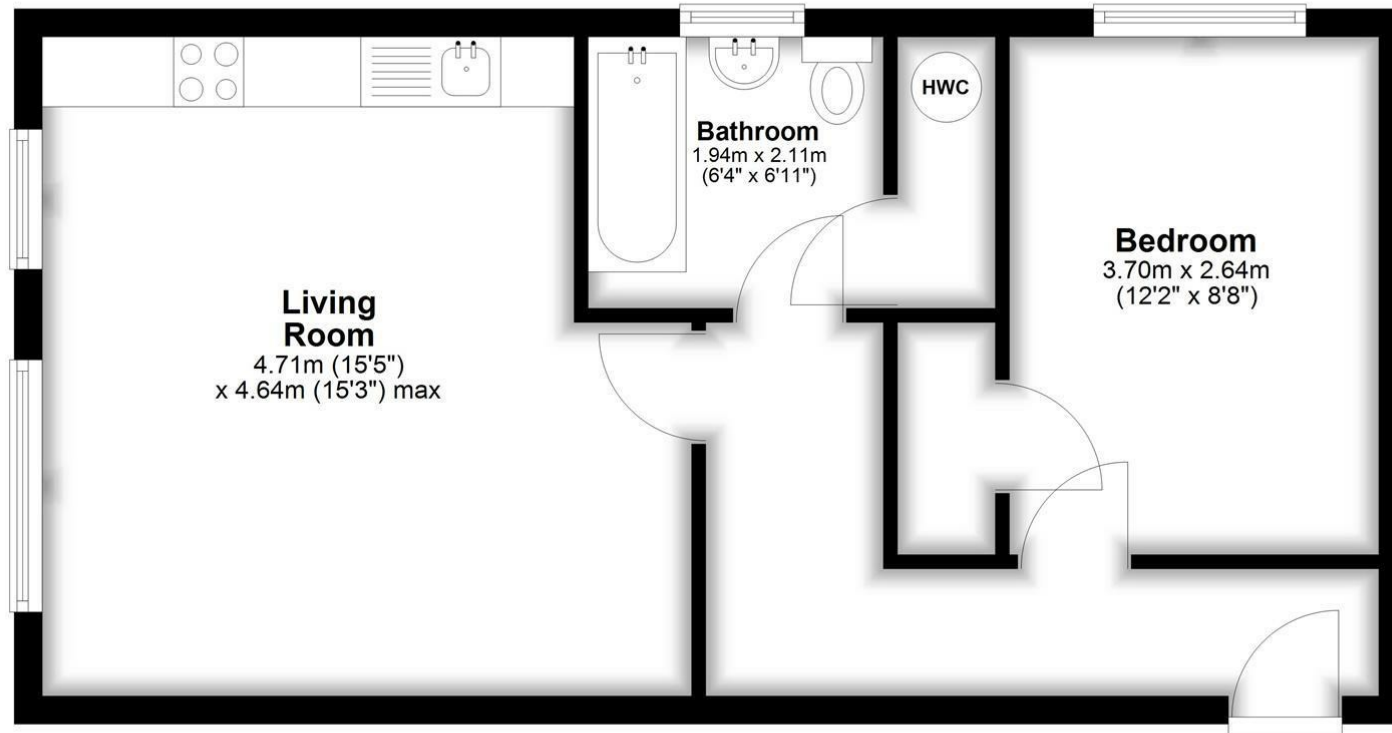

**Living Room**  
4.71m (15'5")  
x 4.64m (15'3") max

**Bathroom**  
1.94m x 2.11m  
(6'4" x 6'11")

**Bedroom**  
3.70m x 2.64m  
(12'2" x 8'8")

Total area: approx. 45.0 sq. metres (484.2 sq. feet)

## Further Information

Let available date: 17th April 2026  
NB: This date is provisional and will only be confirmed once referencing has been successfully completed.

Property type: Flat

Furnish type: Unfurnished

Deposit: £950

Local authority: Wiltshire

Council Tax: Band B

EPC: C(71)

### Energy Efficiency Rating

|   | Current                    | Potential |
|---|----------------------------|-----------|
| Very energy efficient - lower running costs |                            |           |
| (92 plus) <b>A</b>                          |                            |           |
| (81-91) <b>B</b>                            |                            | <b>84</b> |
| (69-80) <b>C</b>                            | <b>71</b>                  |           |
| (55-68) <b>D</b>                            |                            |           |
| (39-54) <b>E</b>                            |                            |           |
| (21-38) <b>F</b>                            |                            |           |
| (1-20) <b>G</b>                             |                            |           |
| Not energy efficient - higher running costs |                            |           |
| <b>England &amp; Wales</b>                  | EU Directive<br>2002/91/EC |           |